

Adjustments

This Öhlins steering damper features an adjustment knob with approximately 16 positions and counts in number of clicks from maximum hard to soft.

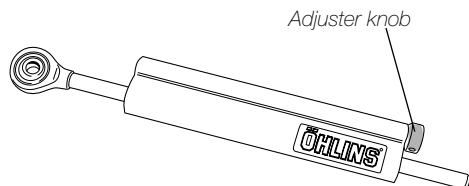

NOTE!

Before riding, always ensure that the basic settings made by Öhlins are intact.

Set-up data

Recommended 10 clicks

NOTE!

When delivered, the Öhlins steering damper is dialed to recommended settings for the specific brand and make of the motorcycle. If you have changed the settings, reset according to the set-up data.

The adjusters have a normal right hand thread. Turn clockwise to fully closed, position 0 (zero) clicks. Turn counter clockwise to open. Count the clicks until you reach the recommended number. See set-up data in this manual.

CAUTION!

Do not use force, delicate sealing surfaces can be damaged. The adjuster should only be hand tightened.

Mounting Instructions

Öhlins steering damper kit SD 187
for Suzuki GSXR600/ 750/ 1000

Kit Contents

Before installing the steering damper, please check the contents of the kit. If anything is missing, please contact your Öhlins dealer.

	Part number
Steering damper, stroke 68	02260-20 (1)
Bracket assembly	02230-04 (1)
Screw M8 x 40	01046-21 (1)
Spacer (8/13/10)	00805-01 (1)
Screw M8 x 30	01046-30 (1)
Washer	00153-01 (2)
Teflon spacer	02259-01 (1)
Öhlins sticker	00192-01 (2)
Öhlins sticker, transparent	00194-10 (2)
Öhlins Owner's Manual	(1)

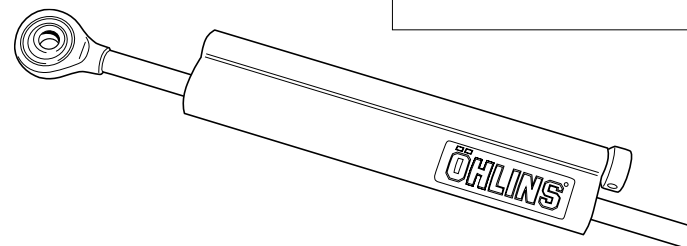

Öhlins products are subject to continuous improvement and development. Consequently, although these instructions include the most up-to-date information available at the time of printing, there may be minor differences between your steering damper and this manual. Please consult your Öhlins dealer if you have any questions regarding the contents of this manual.

Before Installing

Öhlins Racing AB cannot be held responsible for any damage to the steering damper or vehicle, or injury to persons, if the instructions for fitting and maintenance are not followed exactly. Similarly, the warranty will become null and void if the instructions are not adhered to.

SD 187_4, issued 2008 06 26



Öhlins Racing AB, Box 722, S-194 27 Upplands Väsby, Sweden.
Phone +46 8 590 025 00. Fax +46 8 590 025 80.

www.ohlins.com

© Öhlins Racing AB. All rights reserved. Any reprinting or unauthorized use without the written permission of Öhlins Racing AB is prohibited. Printed in Sweden.



Safety Signals

Important information concerning safety is distinguished in this manual by the following notations:



The Safety alert symbol means:
Attention! Your safety is involved.

WARNING!

Failure to follow these warning instructions could result in **severe or fatal injury** to anyone working with, inspecting or using the steering damper, or to bystanders.

CAUTION!

Caution indicates that special precautions must be taken to avoid damage to the steering damper.

NOTE!

Indicates information that is of importance regarding mounting procedures.

WARNING!

1. Installing a steering damper, that is not approved by the vehicle manufacturer, may affect the stability of your vehicle. Öhlins Racing AB cannot be held responsible for any personal injury or damage that may occur after fitting the steering damper.

2. Please study and make certain that you fully understand all the mounting instructions and the owner's manual before handling this steering damper kit. If you have any questions regarding proper installation procedures, contact an Öhlins dealer.

3. The vehicle service manual must be referred to when installing the Öhlins steering damper

During storage and transport, especially at high ambient temperature, the oil and grease used for assembling may run out inside the packing and damage the expanded polystyrene packing material. This is not unusual and is in no way detrimental to the steering damper.

Mounting Instructions

WARNING!

1. It is advisable to have an Öhlins dealer install the steering damper.
2. Follow the instructions in the vehicle service manual when changing the steering damper.
3. When working on a raised vehicle, make sure that it is securely supported to prevent it from tipping.

1

Put the motorcycle on a stand.

2

Loosen and remove the cover underneath the lower triple clamp.

3

Loosen and remove the original steering damper.

4

Install the Öhlins steering damper to the bracket assembly (02230-04). **Install it according to the figure.**

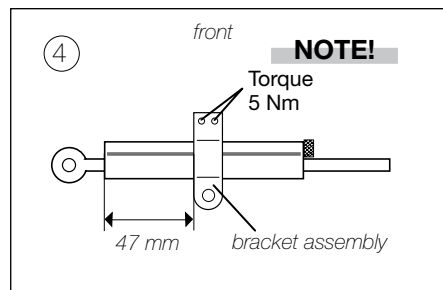

NOTE!

Steps 5 - 8 are divided into two different groups depending on the vehicle model. **Make sure you follow the correct procedure.**

Model:

Suzuki GSXR 600 2001 - 2005
Suzuki GSXR 750 2000 - 2005
Suzuki GSXR 1000 2001 - 2006

5

Install the Öhlins steering damper to the original mounting points. Use the screw (01046-21), spacer (00805-01) and the original nut to the bracket in the triple clamp.

6

Use the original screw and nut to the frame mounting point. Use one support washer only. Install the teflon spacer between the Öhlins bracket and the support washer.

NOTE!

No nut or washers are used on the GSXR 1000 models from 2003.

NOTE!

Make sure there is clearance when turning the steering to the left and right end positions and that the damper is not used as a stop.

7

Tighten the bolts to the correct torque. Consult your vehicle service manual for correct torque.

8

Read more about the steering damper and its different settings in your Öhlins Owners Manual.

NOTE!

Make sure that all bolts are tightened to the correct torque, and that nothing fouls or restricts movement of the steering damper.

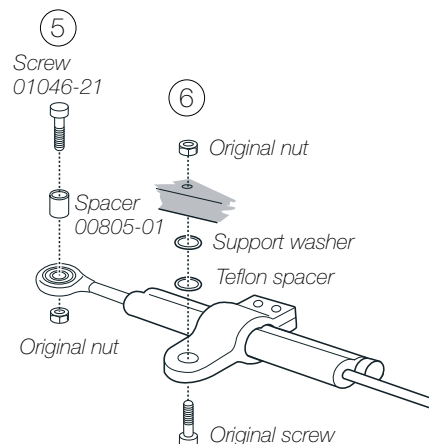

Model:

Suzuki GSXR 600 2006 -
Suzuki GSXR 750 2006 -
Suzuki GSXR 1000 2007 -

5

Install the Öhlins steering damper to the original mounting points. Use the screw (01046-21), spacer (00805-01) and the original nut to the bracket in the triple clamp.

6

Use the screw (1046-30) and washers (00153-01) provided in this kit. Install the teflon spacer between the Öhlins bracket and the washers.

NOTE!

Make sure there is clearance when turning the steering to the left and right end positions and that the damper is not used as a stop.

7

Tighten the bolts to the correct torque. Consult your vehicle service manual for correct torque.

8

Read more about the steering damper and its different settings in your Öhlins Owners Manual.

NOTE!

Make sure that all bolts are tightened to the correct torque, and that nothing fouls or restricts movement of the steering damper.

